

Granada

Cruising Line



Granada 35



LQA	10,68 m
LWL	9,22 m
Beam	3,63 m
Draft	1,55/1,85 m
Dplc	6.500 kg
Keel	2.500 kg
Mainsail	31,20 m ²
Jib	30,50 m ²
Stormjib	10,00 m ²
Genoa I	49,10 m ²
Genoa II	40,30 m ²
Spinnaker	119,00 m ²
Motor	Volvo Penta 2003S/28 HP
Design	K. Rode



LOA	9,39 m
LWL	7,39 m
Bearn	3,05 m
Draft	1,45/1,75 m
Dplc	4.000 kg
Keel	1.700 kg
Mainsail	21,10/27,30 m ²
Jib	20,00/19,20 m ²
Stormjib	7,8/6,0 m ²
Genoa I	32,3/30,70 m ²
Genoa II	27,20/24,20 m ²
Spinnaker	83,00/73,00 m ²
Motor	2002S/18 HP
Design	Elvstrøm & Kjærulff

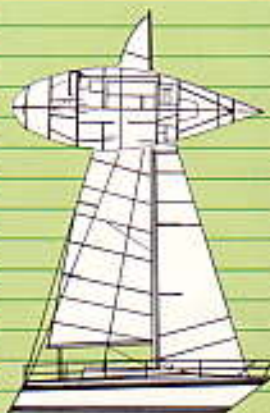

Granada 910



LOA	9,10 m
LWL	7,41 m
Bearn	2,90 m
Draft	1,40/1,70 m
Dplc.	3,200 kg
Keel	1,700 kg
Mainsail	22,70 m ²
Jib	16,80 m ²
Stormjib	6,00 m ²
Genoa I	26,30 m ²
Genoa II	22,80 m ²
Spinnaker	67,80 m ²
Motor	Bukh DV 8 SME
Design	Elvstrøm & Kjærulff





LOA	8,58 m
LWL	6,80 m
Beam	2,92 m
Draft	1,25/1,60 m
Dp/c	2,950 kg
Keel	1,400 kg
Mainsail	21,50 m ²
Jib	16,30 m ²
Stormjib	6,00 m ²
Cenoa I	25,40 m ²
Cenoa II	19,70 m ²
Spinnaker	63,10 m ²
Motor	Bjkh DV 8 SME
Design	Eivstrem & Kjaerulff



Granada 767

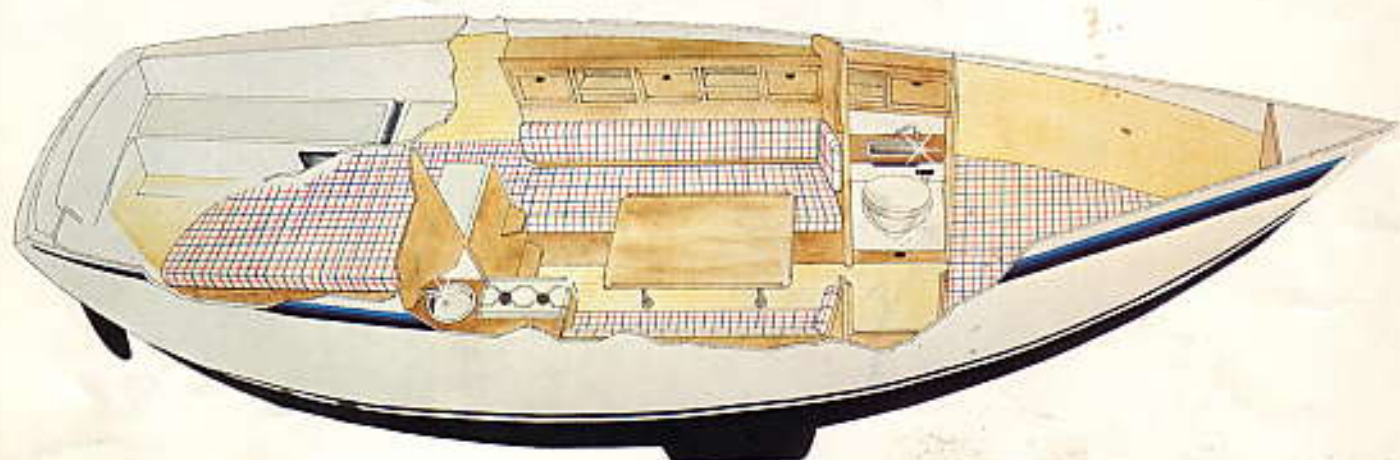

Bentzen/Bojarski

Granada

Vestre Stationsvej 47, DK-6621 Gesten, Tlf. 05-55 71 11



LOA	7,67 m
LWL	6,50 m
Beam	2,70 m
Draft	1,10/1,45 m
Dplc.	1.800 kg
Keel	900 kg
Mainsail	17,10 m ²
Jib	13,30 m ²
Stormjib	6,00 m ²
Cenoa I (145%)	19,30 m ²
Spinnaker	47,40 m ²
Motor	Outboard/inboard
Design	Niels Jeppesen